

# LightLine Step up.

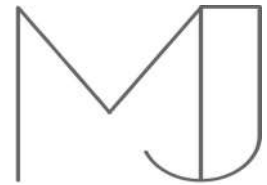

MADE IN BRITAIN



## Features.

Extruded anodised aluminium in bespoke lengths,  
Suitable for surface mounting on edge of steps,  
Walkover, non slip feature  
Multiple light output options – white / colour  
Homogenous glow with 120 pitch  
Flush fitting cover

## Accessories.

Multiple control gear options available

## Specification.

Input Voltage (Volts DC)	12 VDC (24 on request)
LED	60, 120e, 120,
Power	4.8, 9.6, 14.4 W / m
Colour Temperature (CT)	2300 K, 2700 K, 3000 K, 4500 K, 500 K
3ch and 4ch options	RGB, RGB-W, RGB-A
Covers	Clear, Opal
IP Rating	IP50, IP54, IP65,
CRI	83, 93
Estimated LED Lifespan	50,000Hrs
LED	Epistar
Beam Angle	120°
Operating Temperature	-20°C to +45°C

## Light Output.

(lumen/metre of LED internal)

	60 LED	120e LED	120 LED
3000K	310	640	1200
4500K	320	660	1320
6500K	380	780	1500

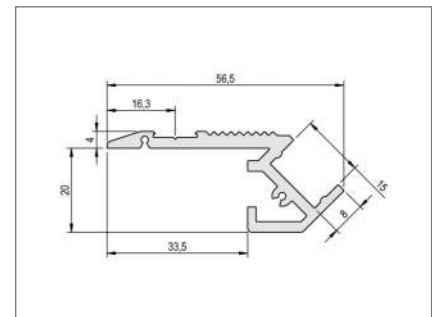

Product specification subject to change without prior notice.

